

Copyright of this drawing is the property of Urban Edge Architecture Limited. It must not be reproduced or amended without the express consent in writing of Urban Edge Architecture Limited.

UrbanEdge Architecture Limited  
 One Scogate Meads, Scogate,  
 Stamford, Lincolnshire, PE9 2FX,  
 Tel: +44 (0)1780 755665  
 Fax: +44 (0)1780 755360

**DRAWING TO BE READ IN COLOUR**

**LEGEND:**

- APPLICATION SITE BOUNDARY
- CARE VILLAGE PHASE 1, UNDER CONSTRUCTION AS APPROVED BY OUTLINE PERMISSION 17/01615/OUTS AND RM APPROVAL 20/0689/RES3

**NOTE:**  
 ALL SITE CONSTRAINTS INDICATED ARE SUBJECT TO DETAILED SITE SURVEYS.  
 THE SITE BOUNDARY (RED LINE) IS DEPICTED IN ACCORDANCE WITH THE GUIDELINES Laid OUT IN HM LAND REGISTRY PLANS, PRACTICE GUIDE 40, SUPPLEMENT 3.

**NOTE:**  
 THE OUTSIDE EDGE OF THE RED LINES DENOTE THE EXTENT OF THE SITE BOUNDARY. THE THICKNESS IS FOR DRAWING REPRESENTATION ONLY.

**NOTE:**  
 SITE INFORMATION SHOWN IS BASED ON SURVEY DRAWINGS RECEIVED FROM HAMPDEN LAND SURVEYS LTD. SITE SURVEY EXISTING DRC: 1849.03.16.06 DATED MARCH 2016.  
 LAMARCO SOLUTIONS THEE SURVEY & CONSTRAINTS PLAN, DWG No. 01 DATED 04/11/2016.

Ordinance Survey (© Crown Copyright 2017. All rights reserved.  
 Licence number: 100026242)

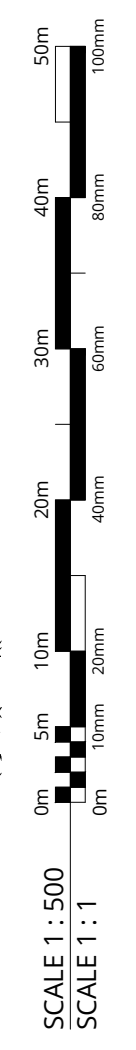
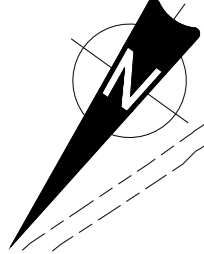
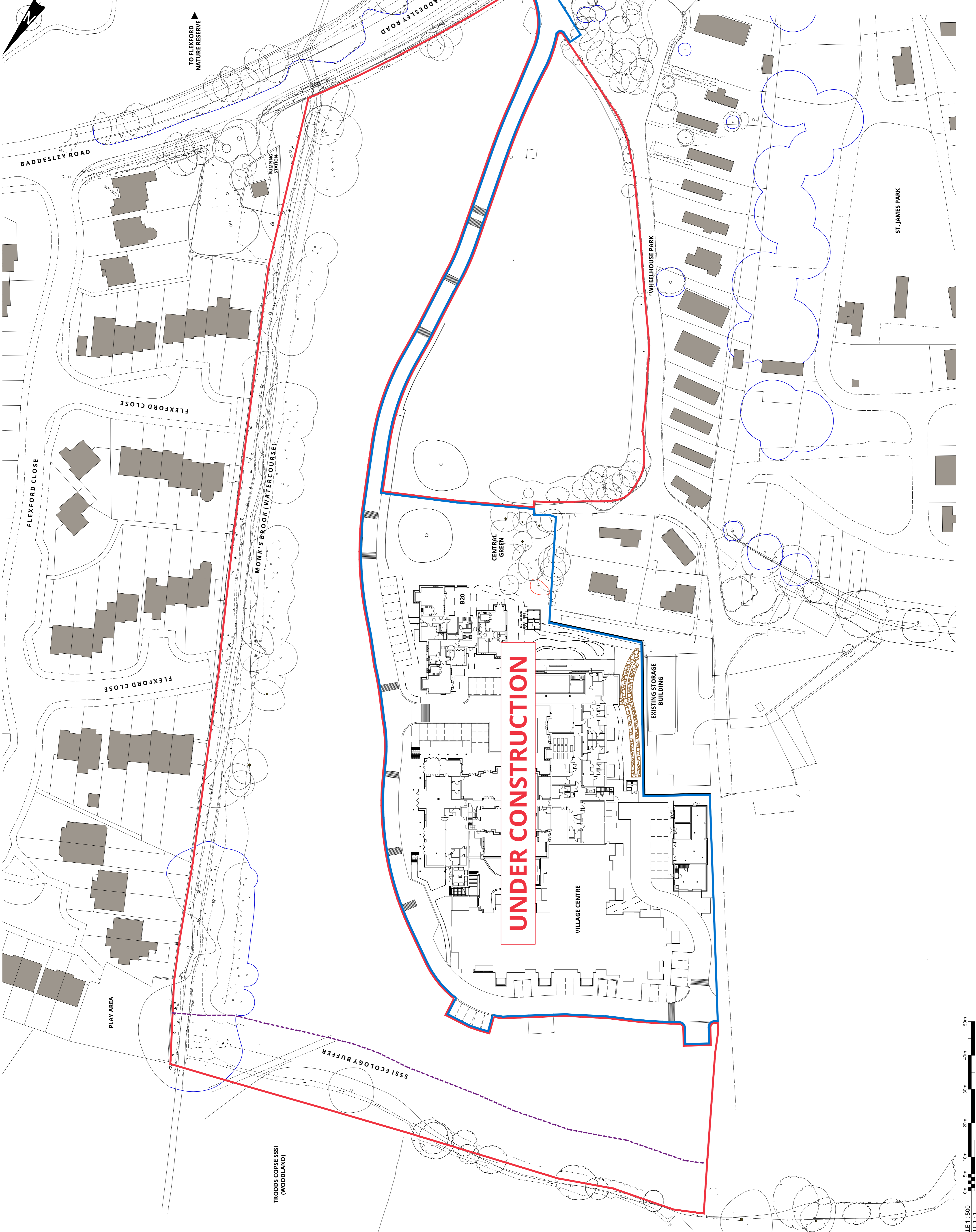

P00 ISSUED FOR PLANNING. DH 09.08.23  
 Rev No Description Drawn By Date



Client: SENIOR LIVING (CHANDLER'S FORD) LIMITED

Project: CHANDLER'S FORD CONTINUING CARE RETIREMENT COMMUNITY PHASE 2 & 3

Drawing: SITE LAYOUT PLAN AS EXISTING

Planning 2496

Issue: 1.500 @ A1 JULY 2023  
 Status: DH  
 Author: P00  
 2496-URB-CF-00-DR-A-208110